

RECORDING REQUESTED BY
PATRICK J. MINTURN
RETURN TO:
SHASTA COUNTY DEPARTMENT OF PUBLIC WORKS
1855 PLACER STREET
REDDING, CA 96001

NO FEE - COUNTY BUSINESS
GOVERNMENT CODE §-6103
AP NO. 087-030-018 (a portion)
PROJECT: Gas Point Rd. Widening (ROAD)

DPW NO. 1H01B-2017-08

-----Space above this line for Recorder's use only-----
UNINCORPORATED AREA DTT = \$0 - R&T §11922

EASEMENT DEED

IN CONSIDERATION, receipt of which is hereby acknowledged,

NANCY D. GARBER, TRUSTEE OF THE NANCY D. GARBER REVOCABLE TRUST 2011, DATED DECEMBER 15, 2011, HEREBY GRANTS to the **COUNTY OF SHASTA**, a political subdivision of the State of California, a permanent easement for public purposes in, upon, over, under, across and along the following described real property situated in the northwest one-quarter of Section 9, Township 29 North, Range 4 West, M.D.B. & M., in the unincorporated area of County of Shasta, State of California, more particularly described in **EXHIBITS 'A' and 'B'**, attached hereto and made a part hereof.

NANCY D. GARBER REVOCABLE TRUST 2011,
DATED DECEMBER 15, 2011

By 
NANCY D. GARBER, TRUSTEE

Dated 01-05-2018

COUNTY OF SHASTA

STATE OF CALIFORNIA

EASEMENT DEED

**NANCY D. GARBER, TRUSTEE OF THE NANCY D. GARBER
REVOCABLE TRUST 2011, DATED DECEMBER 15, 2011**

TO

COUNTY OF SHASTA

(CERTIFICATE OF ACCEPTANCE, GOVERNMENT CODE, SECTION 27281)

THIS IS TO CERTIFY that the interest in real property conveyed by the deed or grant dated _____, from NANCY D. GARBER, TRUSTEE OF THE NANCY D. GARBER REVOCABLE TRUST 2011, DATED DECEMBER 15, 2011, to the COUNTY OF SHASTA, State of California, a governmental agency (a political subdivision of the State of California) is hereby accepted by order of the Board of Supervisors on _____, and the grantee hereby consents to the recordation thereof by its duly authorized officer.

IN WITNESS WHEREOF, I have hereunto set my hand this _____ day of _____, 201_.

LAWRENCE G. LEES
Clerk of the Board of Supervisors

By _____
Deputy

ACKNOWLEDGMENT

A notary public or other officer completing this certificate verifies only the identity of the individual who signed the document to which this certificate is attached, and not the truthfulness, accuracy, or validity of that document.

State of California
County of Shasta)

On January 5, 2018 before me, J. Andrews, A Notary Public
(insert name and title of the officer)

personally appeared Nancy D. Garber,
who proved to me on the basis of satisfactory evidence to be the person~~(s)~~ whose name~~(s)~~ is/~~are~~
subscribed to the within instrument and acknowledged to me that ~~he~~/she/~~they~~ executed the same in
~~his~~/her/~~their~~ authorized capacity(ies), and that by ~~his~~/her/~~their~~ signature~~(s)~~ on the instrument the
person~~(s)~~, or the entity upon behalf of which the person~~(s)~~ acted, executed the instrument.

I certify under PENALTY OF PERJURY under the laws of the State of California that the foregoing paragraph is true and correct.

WITNESS my hand and official seal.

Signature



(Seal)



Legal Description Garber
– Gas Point Road Widening Project

EXHIBIT "A"

All that portion of real property situated in the northwest one-quarter of Section 9, Township 29 North, Range 4 West, M.D.B. & M., in the unincorporated area of the County of Shasta, State of California, as conveyed to Nancy D. Garber as Trustee of the Nancy D. Garber Revocable Trust 2011, dated December 15, 2011, by deed recorded December 20, 2011 in Official Records Document 2011-0038888, Shasta County Records, lying northerly of a Right of Way line as shown on Exhibit "B", attached hereto and made a part thereof, said Right of Way line lying 44.00 feet Southerly of and parallel with the centerline of monumentation for construction of a portion of Gas Point Road, Shasta County road No. 1H01B, as shown on that certain Record of Survey for Gas Point Road filed June 23, 2017 in Book 59 of Land Surveys at Page 30, Shasta County Records.

Being a portion of APN 087-030-018



EXHIBIT "B"

SCALE 1"=80'



086-160-021
THARP, BILLY D.
AND MARY A.

086-160-020
PARKS, BRYAN F.
AND SANDRA J.

086-160-019
DEESE, DOUGLAS
AND CYNTHIA TR.

"G" LINE
GAS POINT ROAD
CENTERLINE OF
MONUMENTATION
PER 59 LS 30

EXISTING EDGE
OF PAVEMENT

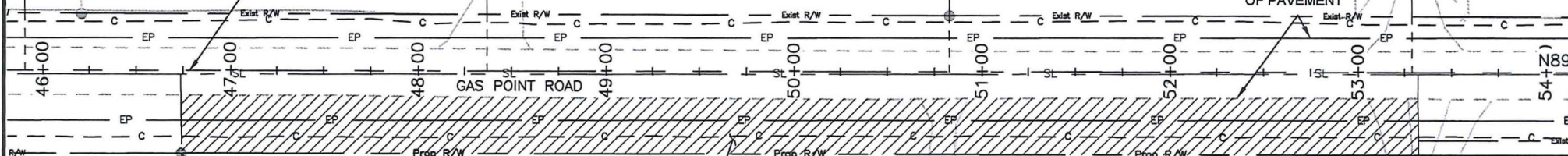

STA: "G" 46+73.99
O/S: 44.00' RT.

PROPOSED
ROAD RIGHT OF WAY
ACQUISITION AREA

STA: "G" 53+32.33
O/S: 44.00' RT.

N89°31'09"E 10

087-030-018
GARBER, NANCY D.

087-030-015
RICHARDS, THOMAS J.
AND LISA R.

087-020-009
DALE, RICH AND LINDA

