

RECORDING REQUESTED BY
PATRICK J. MINTURN
RETURN TO:
SHASTA COUNTY DEPARTMENT
OF PUBLIC WORKS
1855 PLACER STREET
REDDING, CA 96001

NO FEE - COUNTY BUSINESS
GOVERNMENT CODE §-6103
AP NO. 060-660-061 (a portion)
PROJECT: OLD 44 DRIVE @ OAK RUN CREEK
BRIDGE REPLACEMENT PROJECT (ROAD)
DPW NO. 3H05-2015-01

-----Space above this line for Recorder's use only-----
UNINCORPORATED AREA DTT = \$0 - R&T \$11922

EASEMENT DEED

IN CONSIDERATION, receipt of which is hereby acknowledged,

ROBERT M. CRONIC AND MICHELE I. CRONIC, TRUSTEES OF THE ROBERT AND MICHELE CRONIC TRUST OF JUNE 14, 2000, HEREBY GRANTS to the **COUNTY OF SHASTA**, a political subdivision of the State of California, a permanent easement for public purposes in, upon, over, under, across and along the following described real property situated in the South one-half of Section 3, Township 31 North, Range 3 West, M.D.B.&M., in the unincorporated area of County of Shasta, State of California, more particularly described in **EXHIBITS 'A' and 'B'**, attached hereto and made a part hereof.

THE ROBERT AND MICHELE CRONIC
TRUST OF JUNE 14, 2000

By  Dated 6/20/17
ROBERT M. CRONIC, TRUSTEE

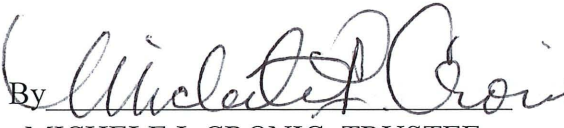
By  Dated 6-20-17
MICHELE I. CRONIC, TRUSTEE

COUNTY OF SHASTA

STATE OF CALIFORNIA

EASEMENT DEED

**ROBERT M. CRONIC AND MICHELE I. CRONIC,
TRUSTEES OF THE ROBERT AND MICHELE CRONIC TRUST OF
JUNE 14, 2000**

TO

COUNTY OF SHASTA

(CERTIFICATE OF ACCEPTANCE, GOVERNMENT CODE, SECTION 27281)

THIS IS TO CERTIFY that the interest in real property conveyed by the deed or grant dated _____, from ROBERT M. CRONIC AND MICHELE I. CRONIC, TRUSTEES OF THE ROBERT AND MICHELE CRONIC TRUST OF JUNE 14, 2000 to the COUNTY OF SHASTA, State of California, a governmental agency (a political subdivision of the State of California) is hereby accepted by order of the Board of Supervisors on _____, and the grantee hereby consents to the recordation thereof by its duly authorized officer.

IN WITNESS WHEREOF, I have hereunto set my hand this _____ day of _____, 2017.

LAWRENCE G. LEES
Clerk of the Board of Supervisors

By _____
Deputy

Legal Description – Cronic, Robert M. and Michele I.
Old 44 Drive @ Oak Run Creek Bridge Replacement Project

EXHIBIT "A"

PARCEL ONE

All that real property situated in the South one half of Section 3, Township 31 North, Range 3 West, M.D.B.&M., in the unincorporated area of County of Shasta, State of California, as conveyed to Robert M. Chronic and Michele I. Cronic, Trustees of the Robert and Michele Chronic Trust of June 14, 2000 in Official Records Document 2007-0024318, Shasta County Records, lying northerly and easterly of the proposed Right of Way line as shown on Exhibit "B" attached hereto and made a part thereof, said Right of Way line lying 40.00 feet westerly of and parallel with the centerline of monumentation for Forty Four Drive, Shasta County Road No. 3H05, as shown on that certain Record of Survey for Old Forty Four Drive filed September 14, 2015 in book 58 of Land Surveys at page 122, Shasta County Records.

Being a portion of APN 060-660-061

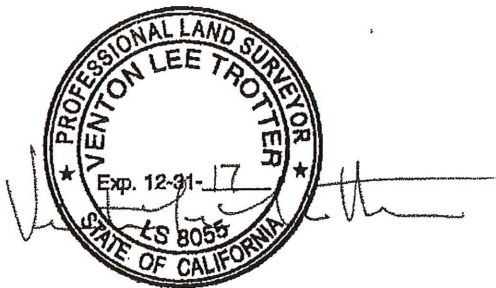

EXHIBIT "B"

SCALE 1"=50'



060-720-010
MYERS, TRUE E. AND LESLIE A.

060-720-011
SLETNER, DONALD R.
AND BARBARA J.

OAK RUN

"O" LINE
OLD 44 DR.
CENTERLINE OF
MONUMENTATION
PER 58 LS 122

2" BRASS DISK STAMPED
"SHASTA COUNTY SURVEYOR
LS 8055"

EXISTING EDGE
OF PAVEMENT

STA. "O" 15+35.00 P.O.T.

STA: "O" 12+60.49
OFF: 0.88' RT.

CREEK

STA. "O" 12+73.15
O/S 40.00' RT.

PROPOSED ROAD
RIGHT OF WAY
ACQUISITION AREA

STA. "O" 15+10.00
O/S 40.00' RT.

S73° 17' 45"W 40'
STA. "O" 15+10.00
O/S 0.00'

060-660-061
CRONIC, ROBERT M.
AND , MICHELE I. TR

060-660-016 MASINGALE, RONALD G.
AND LOUISE E. TR



CALIFORNIA ALL-PURPOSE ACKNOWLEDGMENT**CIVIL CODE § 1189**

A notary public or other officer completing this certificate verifies only the identity of the individual who signed the document to which this certificate is attached, and not the truthfulness, accuracy, or validity of that document.

State of California)

County of SHASTA)On JUNE 23, 2017 before me, BRANDON H. MAGBY, NOTARY PUBLIC,
Date Here Insert Name and Title of the Officerpersonally appeared ROBERT M. CRONIC AND MICHELE I. CRONIC
Name(s) of Signer(s)

who proved to me on the basis of satisfactory evidence to be the person(s) whose name(s) is/are subscribed to the within instrument and acknowledged to me that he/she/they executed the same in his/her/their authorized capacity(ies), and that by his/her/their signature(s) on the instrument the person(s), or the entity upon behalf of which the person(s) acted, executed the instrument.

I certify under PENALTY OF PERJURY under the laws of the State of California that the foregoing paragraph is true and correct.

WITNESS my hand and official seal.

Signature [Signature]
Signature of Notary Public

Place Notary Seal Above

OPTIONAL

Though this section is optional, completing this information can deter alteration of the document or fraudulent reattachment of this form to an unintended document.

Description of Attached Document

Title or Type of Document: _____ Document Date: _____

Number of Pages: _____ Signer(s) Other Than Named Above: _____

Capacity(ies) Claimed by Signer(s)

Signer's Name: _____

☐ Corporate Officer — Title(s): _____☐ Partner — ☐ Limited ☐ General☐ Individual ☐ Attorney in Fact☐ Trustee ☐ Guardian or Conservator☐ Other: _____

Signer Is Representing: _____

Signer's Name: _____

☐ Corporate Officer — Title(s): _____☐ Partner — ☐ Limited ☐ General☐ Individual ☐ Attorney in Fact☐ Trustee ☐ Guardian or Conservator☐ Other: _____

Signer Is Representing: _____